

Rieke Packaging System® Customer Plastic Product Specification		
Description	PX-1, 3/4" <b>SAFESEAL®</b> ASSEMBLY	
Specification number	Item Number: 01050001	
Date	May 16, 2014	Page 1 of 1
Prepared by	Jeff Hess	
Approved by	Lee Olinske	

PARAMETERS	SPECIFICATION	TEST METHOD
Material of construction	Type:- Polyethylene & Aluminium	COA
Standard Color (other colors available upon request)	White	QC Spec Visual
Nominal dimensions in inches (mm)		QC Spec Variable/Attribute Gauge
Opening Print Drawing Number	M0665 Rev: D	
Special markings		
Accessories		
Applied torque		QC Spec Torque Wrench
Method of delivery	1000 /carton - ~ 9 lbs gross/carton - 32 cartons/pallet	
Components	Lid / Retainer	Drawing No. 28000431 Rev: F

LOW DENSITY  
POLYETHYLENE

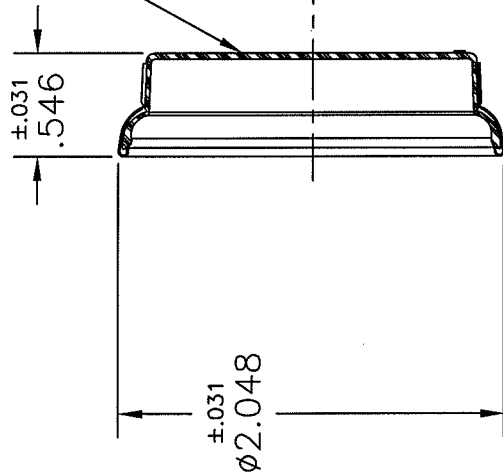

TIN PLATE  
OR ALUMINUM

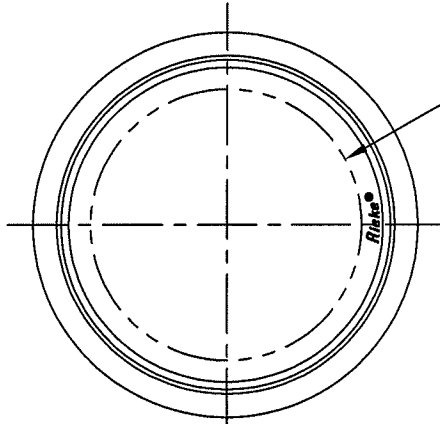

1.43 MAX PRINTING  
DIAMETER

CUSTOMER DRAWING

<b>Safe Seal</b> Corporation — Auburn, Indiana DETAIL NAME 3/4" SAFESEAL ASSEMBLY	
TOOL ASSY. NAME	
PRODUCT	PX-1
DRAWING NUMBER	28000431
FOR	
MATERIAL	AS NOTED
TEMPER	PX-1
TOOL ASSY NUMBER	
DETAIL NUMBER	

BREAK ALL SHARP EDGES WITH 1/64" RADIUS, UNLESS OTHERWISE SPECIFIED THE FOLLOWING TOLERANCES APPLY UNLESS OTHERWISE SPECIFIED:	DATE	10-20-06	DRAWN BY	J. HESS
	SCALE	NTS	CHECKED	JPZ
ANGLES	±1/4°		APPROVED	
HUNDRETH	±.015		CHANGE NUMBER	F
THOUSANDTH	±.002		REDRAWN IN CAD	CHANGE
		10-20-06	DATE	BY
		JLH		